

## Sealed fittings

Straight & 90° Elbow threaded fittings (Metric versions)



### Threaded fittings (Metric versions)

Straight and 90° Elbow compression type fittings incorporating fixed or swivel male threads to provide connection to knockouts and threaded entries. These fittings are designed for use with all types of unsplit Harnessflex conduit, maintaining maximum conduit bore.

### Threaded fittings (Metric versions)

Metric thread	Conduit size			Straight	90° Elbow	Seal	Capnut	Configuration
	NC	NW	US					
M16	08	7.5	¼	AB12-M16	–	RSB12-08	CN09-08	B
				AB16-M16	AB16-M16-90	RSB16-08	CN11-08	B
	10	8.5	5/16	AB12-M16	–	SRN07	CN07	A
				AB12-M16	–	SRN09	CN09	A
	12	10	5/16	AB16-M16	AB16-M16-90	RSB16-12	CN11-12	B
AB16-M16				AB16-M16-90	SRN11	CN11	A	
M20	08	7.5	¼	AB12-M20	–	RSB12-08	CN09-08	B
				AB16-M20	AB16-M20-90	RSB16-08	CN11-08	B
				AB20-M20	AB20-M20-90	RSB20-08	CN16-08	B
	10	8.5	5/16	AB12-M20	–	SRN07	CN07	A
				AB12-M20	–	SRN09	CN09	A
	12	10	5/16	AB16-M20	AB16-M20-90	RSB16-12	CN11-12	B
				AB20-M20	AB20-M20-90	RSB20-12	CN16-12	B
				AB16-M20	AB16-M20-90	SRN11	CN11	A
16	12	¾	AB20-M20	AB20-M20-90	RSB20-16	CN16-16-HF	B	
			AB20-M20	AB20-M20-90	SRN16	CN16	A	
M25	12	10	5/16	AB25-M25	AB25-M25-90	RSB28-12	CN21-12	B
				AB25-M25	AB25-M25-90	RSB28-16	CN21-16	B
	20	17	½	AB25-M25	AB25-M25-90	RSB28-20	CN21-20	B
				AB25-M25	AB25-M25-90	SRN21	CN21	A
	28	23	¾	AB25-M25	AB25-M25-90	SRN28	CN28-HF	A
M32	20	17	½	AB32-M32	AB32-M32-90	RSB32-20	CN32-20	B
				AB32-M32	AB32-M32-90	RSB32-25	CN32-25	B
	25	22	¾	AB32-M32	AB32-M32-90	RSB32-28	CN32-28	B
				AB32-M32	AB32-M32-90	SRN29	CN32	A
M40	40	36	1 ¼	AB40-M40	AB40-M40-90	SRN36	CN36-HF	A
M50	50	48	1 ½	AB50-M50	AB50-M50-90	SRN48	CN47	A

NOTE: Order fitting bodies, cap nuts, sealing bushes separately.

### Configuration diagram



## Sealed fittings

### Straight & 90° Elbow threaded fittings (Metric versions)

#### Straight (Metric versions)

		Nominal dimensions (mm)					
Straight body		A	B	C	Min bore	A/F size	
Part No.					D	E	F
Straight fitting	AB12-M16	34.0	12.0	23.0	11.0	22.0	17.0
	AB12-M20	37.0	14.0	23.0	15.0	27.0	17.0
	AB12-M16	34.0	12.0	26.0	11.0	22.0	17.0
	AB12-M20	37.0	14.0	26.0	15.0	27.0	17.0
	AB16-M16	35.0	12.0	26.0	11.0	27.0	17.0
	AB16-M20	37.0	14.0	26.0	15.0	27.0	17.0
Straight swivel fitting	AB20-M20	39.0	14.0	31.0	15.0	30.0	20.0
	AB25-M25	43.0	15.0	39.0	19.0	38.0	21.0
	AB25-M25	43.0	15.0	39.0	19.0	38.0	21.0
	AB32-M32	49.0	16.0	46.0	26.0	46.0	27.0
	AB40-M40	59.0	16.0	58.0	31.0	59.0	35.0
	AB50-M50	59.0	16.0	72.0	41.0	73.0	35.0

NOTE: Dimensions refer to an overall assembly.

#### 90° Elbow (Metric versions)

		Nominal dimensions (mm)						
90° Elbow body		A	B	C	Min bore	A/F size	F	G
Part No.					D	E		
90° elbow fitting	AB16-M16-90	46.0	12.0	26.0	15.0	22.0	48.0	17.0
	AB16-M20-90	46.0	13.0	26.0	15.0	27.0	49.0	17.0
	AB20-M20-90	47.0	13.0	31.0	15.0	27.0	51.0	20.0
	AB25-M25-90	56.0	15.0	39.0	20.0	33.0	62.0	21.0
	AB25-M25-90	56.0	15.0	39.0	20.0	33.0	62.0	21.0
	AB32-M32-90	66.0	16.0	46.0	26.0	40.0	76.0	27.0
	AB40-M40-90	77.0	16.0	59.0	34.0	48.0	93.0	35.0
	AB50-M50-90	94.0	16.0	72.0	40.0	59.0	114.0	35.0

NOTE: Dimensions refer to an overall assembly.

## Sealed fittings

Straight & 90° Elbow threaded fittings (PG versions)



### Threaded fittings (PG versions)

Straight and 90° Elbow compression type fittings incorporating fixed or swivel male threads to provide connection to knockouts and threaded entries. These fittings are designed for use with all types of unsplit Harnessflex conduit, maintaining maximum conduit bore.

### Threaded fittings (PG versions)

PG thread	Conduit size			Straight	90° Elbow	Seal	Capnut	Configuration
	NC	NW	US					
PG09	08	7.5	¼	AB12-PG09	AB12-PG09-90	RSB12-08	CN09-08	B
				AB16-PG09	–	RSB16-08	CN11-08	B
	10	8.5	5/16	AB12-PG09	AB12-PG09-90	SRN07	CN07	A
				AB16-PG09	–	RSB16-12	CN11-12	B
	12	10	5/16	AB12-PG09	AB12-PG09-90	SRN09	CN09	A
16	12	¾	AB16-PG09	–	SRN11	CN11	A	
PG11	08	7.5	¼	AB12-PG11	–	RSB12-08	CN09-08	B
				AB16-PG11	AB16-PG11-90	RSB16-08	CN11-08	B
	10	8.5	5/16	AB12-PG11	–	SRN07	CN07	A
				AB16-PG11	AB16-PG11-90	RSB16-12	CN11-12	B
	12	10	5/16	AB12-PG11	–	SRN09	CN09	A
16	12	¾	AB16-PG11	AB16-PG11-90	SRN11	CN11	A	
PG13	08	7.5	¼	AB12-PG13	–	RSB12-08	CN09-08	B
				AB16-PG13	–	RSB16-08	CN11-08	B
	10	8.5	5/16	AB12-PG13	–	SRN07	CN07	A
				AB16-PG13	–	RSB16-12	CN11-12	B
	12	10	5/16	AB12-PG13	–	SRN09	CN09	A
16	12	¾	AB16-PG13	–	SRN11	CN11	A	
PG16	08	7.5	¼	AB20-PG16	AB20-PG16-90	RSB20-08	CN16-08	B
				AB20-PG16	AB20-PG16-90	RSB20-12	CN16-12	B
	12	10	5/16	AB20-PG16	AB20-PG16-90	RSB20-16	CN16-16-HF	B
				AB20-PG16	AB20-PG16-90	SRN16	CN16	A
PG21	12	10	5/16	AB25-PG21	AB25-PG21-90	RSB28-12	CN21-12	B
				AB25-PG21	AB25-PG21-90	RSB28-16	CN21-16	B
	16	12	¾	AB25-PG21	AB25-PG21-90	RSB28-20	CN21-20	B
				AB25-PG21	AB25-PG21-90	SRN21	CN21	A
	20	17	½	AB25-PG21	AB25-PG21-90	SRN28	CN28-HF	A
PG29	20	17	½	AB32-PG29	AB32-PG29-90	RSB32-20	CN32-20	B
				AB32-PG29	AB32-PG29-90	RSB32-25	CN32-25	B
	25	22	¾	AB32-PG29	AB32-PG29-90	RSB32-28	CN32-28	B
				AB32-PG29	AB32-PG29-90	SRN29	CN32	A
28	23	¾	AB32-PG29	AB32-PG29-90	SRN29	CN32	A	
			AB32-PG29	AB32-PG29-90	SRN29	CN32	A	
PG36	40	36	1 ¼	AB40-PG36	–	SRN36	CN36-HF	A
				AB40-PG36	–	SRN36	CN36-HF	A
PG48	50	48	1 ½	AB50-PG48	–	SRN48	CN47	A

NOTE: Order fitting bodies, cap nuts, sealing bushes separately.

### Configuration diagram

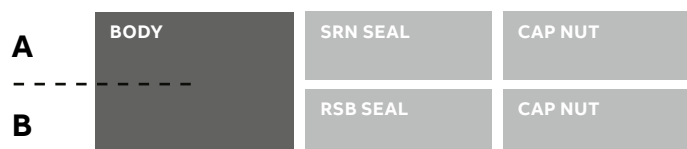

## Sealed fittings

### Straight & 90° Elbow threaded fittings (PG versions)

#### Straight (PG versions)

		Nominal dimensions(mm)					
Straight body		A	B	C	Min bore D	A/F size	
Part No.	E					F	
Straight fitting	AB12-PG09	32.0	10.0	23.0	10.0	22.0	17.0
	AB12-PG11	32.0	10.0	23.0	14.0	22.0	17.0
	AB12-PG13	32.0	10.0	23.0	16.0	22.0	17.0
	AB12-PG09	32.0	10.0	23.0	10.0	22.0	17.0
	AB12-PG11	32.0	10.0	23.0	14.0	22.0	17.0
	AB12-PG13	32.0	10.0	26.0	16.0	27.0	17.0
	AB16-PG09	32.0	10.0	26.0	10.0	27.0	17.0
Straight swivel fitting	AB16-PG11	32.0	10.0	26.0	14.0	27.0	17.0
	AB16-PG13	32.0	10.0	26.0	16.0	27.0	17.0
	AB20-PG16	35.0	11.0	31.0	18.0	30.0	20.0
	AB25-PG21	40.0	12.0	39.0	23.0	38.0	21.0
	AB25-PG21	40.0	12.0	39.0	23.0	38.0	21.0
	AB32-PG29	45.0	12.0	46.0	31.0	46.0	27.0
	AB40-PG36	55.0	12.0	58.0	38.0	59.0	35.0
	AB50-PG48	55.0	12.0	72.0	50.0	73.0	35.0

NOTE: Dimensions refer to an overall assembly.

#### 90° Elbow (PG versions)

		Nominal dimensions (mm)						
90° Elbow body		A	B	C	Min bore D	A/F size		
Part No.	E					F	G	
90° elbow fitting	AB12-PG09-90	46.0	10.0	23.0	11.0	22.0	44.0	17.0
	AB12-PG09-90	46.0	10.0	23.0	11.0	22.0	44.0	17.0
	AB16-PG11-90	46.0	10.0	26.0	14.0	25.0	46.0	17.0
	AB20-PG16-90	46.0	12.0	31.0	15.0	28.0	50.0	20.0
	AB25-PG21-90	56.0	12.0	39.0	22.0	36.0	59.0	21.0
	AB25-PG21-90	56.0	12.0	39.0	22.0	36.0	59.0	21.0
	AB32-PG29-90	66.0	12.0	46.0	29.0	44.0	72.0	27.0

NOTE: Dimensions refer to an overall assembly.

## Sealed fittings

### Circular UNEF connector



#### Circular UNEF connector

Straight compression type fittings providing connection between UNEF style circular connections and conduit systems. These fittings are designed for use with all types of unslit Harnessflex conduit, maintaining maximum conduit bore.

#### Threaded fittings (UNEF versions)

UNEF thread	Conduit size			Body	Seal	Capnut	Face seal	Configuration
	NC	NW	US					
5/8"-24 UNEF	08	7.5	¼	MPA01	RSB12-08	CN09-08	SWPG07	B
	10	8.5	5/16	MPA01	SRN07	CN07	SWPG07	A
	12	10	5/16	MPA01	SRN09	CN09	SWPG07	A
3/4"-20 UNEF	08	7.5	¼	MPA08	RSB12-08	CN09-08	SWPG09	B
	10	8.5	5/16	MPA08	SRN07	CN07	SWPG09	A
	12	10	5/16	MPA08	SRN09	CN09	SWPG09	A
13/16"-18 UNEF	08	7.5	¼	MPA03	RSB20-08	CN16-08	SWPG16	B
	12	10	5/16	MPA03	RSB20-12	CN16-12	SWPG16	B
	16	12	3/8	MPA03	RSB20-16	CN16-16-HF	SWPG16	B
	20	17	½	MPA03	SRN16	CN16	SWPG16	A
1"-20 UNEF	08	7.5	¼	MPA04	RSB20-08	CN16-08	SWM20	B
	12	10	5/16	MPA04	RSB20-12	CN16-12	SWM20	B
	16	12	3/8	MPA04	RSB20-16	CN16-16-HF	SWM20	B
	20	17	½	MPA04	SRN16	CN16	SWM20	A

NOTE: Order connector interface bodies, cap nuts, sealing bushes and sealing washers separately.

#### Circular UNEF connector interfaces

Interface body Part No.	Nominal dimensions (mm)				
	A	B	C	UNEF Thread D	E
MPA01	30.0	24.0	23.0	5/8"-24 UNEF	17.0
MPA03	33.0	36.0	31.0	1"-20 UNEF	20.0
MPA04	32.0	37.0	31.0	13/16"-18 UNEF	20.0
MPA08	30.0	32.0	23.0	3/4"-20 UNEF	17.0

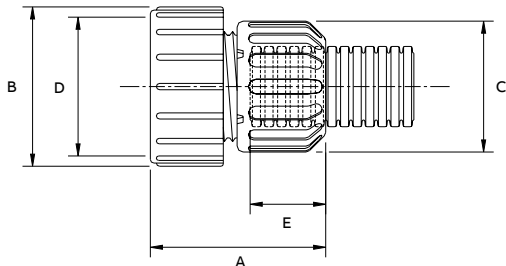

NOTE: Dimensions refer to overall assembly.

#### Configuration diagram

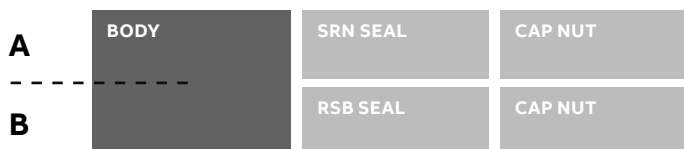

## Sealed fittings

### 90° Flange



90° Flange

#### 90° Flange

90° elbow compression type fitting providing a 4 hole panel mounting facility. These fittings are designed for use with all types of unslit Harnessflex conduit, maintaining maximum conduit bore.

90° Flange Part No.	Conduit Size			Seal	Capnut	Configuration
	NC	NW	US			
AB32-F90	20	20	½	RSB32-20	CN32-20	B
	25	25	¾	RSB32-25	CN32-25	B
	28	28	¾	RSB32-28	CN32-28	B
	32	32	1	SRN29	CN32	A
AB40-F90	40	40	1 ¼	SRN36	CN36-HF	A
AB50-F90	50	50	1 ½	SRN48	CN47	A

NOTE: Order flange bodies, cap nuts and sealing bushes separately.

#### Flange body

Flange body Part No.	Nominal dimensions (mm)									
	A	B	C	D	E	F	G	H	I	J
AB32-F90	66.0	54.0	46.0	36.0	95.0	36.0	17.0	63.0	53.0	27.0
AB40-F90	86.0	73.0	63.0	46.0	115.0	30.0	27.0	77.0	64.0	35.0
AB50-F90	86.0	73.0	73.0	59.0	125.0	30.0	30.0	86.0	77.0	35.0

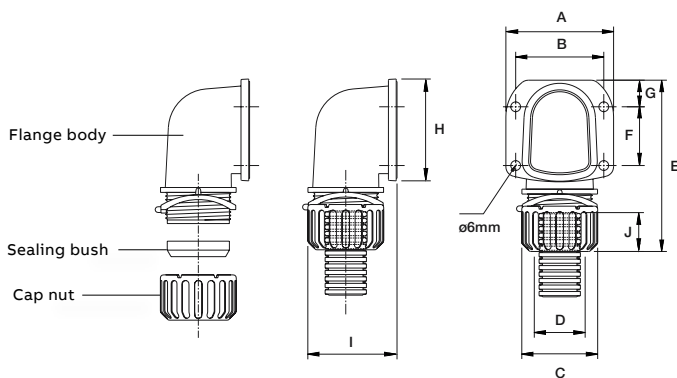

NOTE: Dimensions refer to overall assembly.

#### Configuration diagram

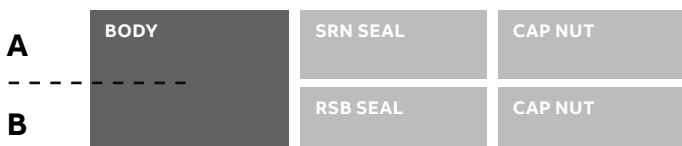

## Sealed fittings

T-Piece, X-piece & Multiway outlet manifolds



### T-piece

Symmetrical, 3 junction compression type fittings providing a variety of conduit size configurations.

### X-piece

Symmetrical 4 junction compression type fitting providing a variety of conduit size configurations.

### Multi-way fitting

Asymmetrical 4 junction compression fitting.

These fittings are designed for use with all types of unslit Harnessflex conduit, maintaining maximum conduit bore.

### Manifolds

Conduit size			T-Body	X-Body	TPM-Body	Seal	Capnut	Configuration
NC	NW	US						
08	7.5	1/4	TP12	-	TPM2512	RSB12-08	CN09-08	B
10	8.5	5/16		-		SRN07	CN07	A
12	10	5/16		-		SRN09	CN09	A
08	7.5	1/4	TP16	-	-	RSB16-08	CN11-08	B
12	12	5/16		-	-	RSB16-12	CN11-12	B
16	16	5/16		-	-	SRN11	CN11	A
08	08	1/4	TP20	XP20	-	RSB20-08	CN16-08	B
12	12	5/16			-	RSB20-12	CN16-12	B
16	16	5/16			-	RSB20-16	CN16-16-HF	B
20	20	1/2			-	SRN16	CN16	A
12	12	5/16	TP28	-	TPM2512	RSB25-12	CN21-12	B
16	16	5/16		-		RSB25-16	CN21-16	B
20	20	1/2		-		RSB25-20	CN21-20	B
25	25	3/4		-		SRN21	CN21	A
28	28	3/4		-		SRN28	CN28-HF	A
20	20	1/2	TP32	-	-	RSB32-20	CN32-20	B
25	25	3/4		-	-	RSB32-25	CN32-25	B
28	28	3/4		-	-	RSB32-28	CN32-28	B
32	32	1		-	-	SRN29	CN32	A

NOTE: Order manifold bodies, cap nuts and sealing bushes separately.

### Configuration diagram



## Sealed fittings

### T-Piece, X-piece & Multiway outlet manifolds

#### T-piece, X-piece & Mutiway manifolds

Manifold	With bracket Part No.	With no bracket	Nominal dimensions (mm)					
			A	B	C	D	E	F
T-Piece	-	TP12	-	68.0	50.0	39.0	27.0	17.0
	-	TP12	-	68.0	50.0	39.0	27.0	17.0
	-	TP16	-	69.0	51.0	38.0	31.0	17.0
	TPB20	TP20	-	80.0	58.0	43.0	35.0	20.0
	TPB28	TP28	-	95.0	71.0	52.0	43.0	21.0
	TPB28	TP28	-	95.0	71.0	52.0	43.0	21.0
	TPB32	-	-	109.0	84.0	61.0	51.0	27.0
X-Piece	XP20	-	-	80.0	-	80.0	35.0	20.0
Multiway	TPM2512	-	105	74.0	55.0	40.0	21.0	17.0

#### T-Piece

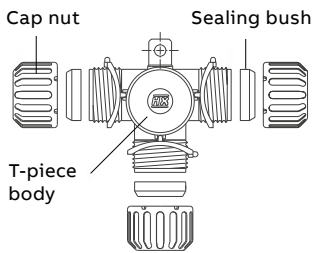

#### X-Piece

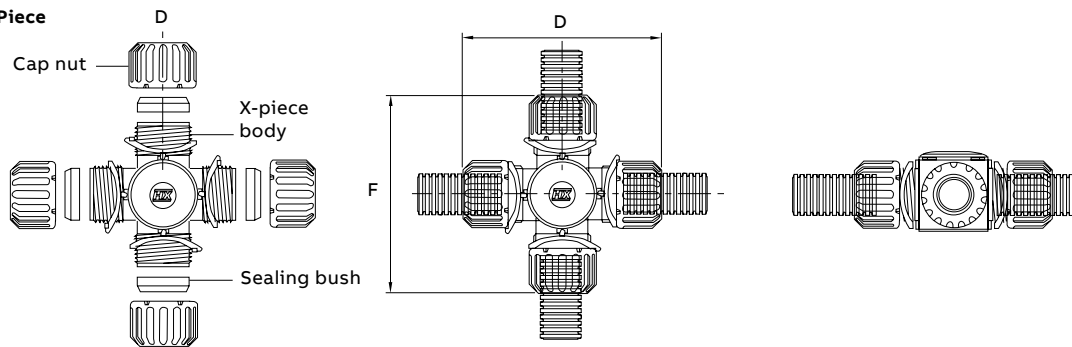

#### Multiway manifold

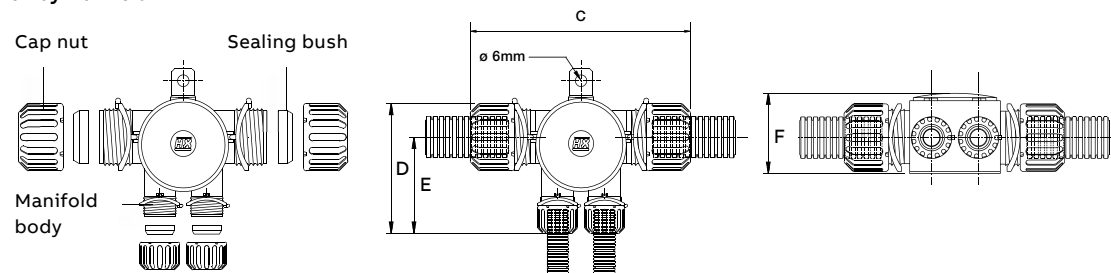

NOTE: Dimensions refer to overall assembly.



## Sealed fittings

### Solenoid connector

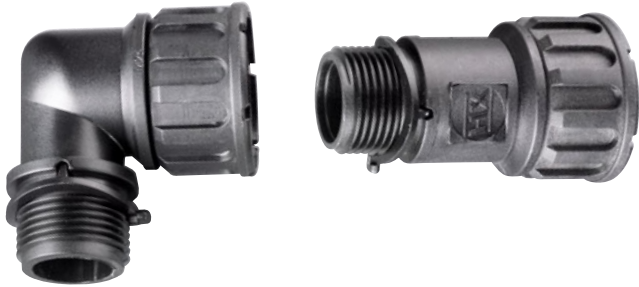

#### Solenoid connector

Screw-thread straight and elbow connectable interfaces for circular solenoids, sensors and switches. These fittings are designed for use with all types of unslit Harnessflex conduit, maintaining maximum conduit bore.

#### Solenoid connector

Solenoid connector Part No.	Conduit Size			Body	Seal	Capnut	Configuration
	NC	NW	US				
SC-M24-S	08	7.5	¼	SC-M24-90	RSB12-08	CN09-08	B
	10	8.5	⅝ <sub>16</sub>	SC-M24-90	SRN07	CN07	A
	12	10	⅝ <sub>16</sub>	SC-M24-90	SRN09	CN09	A
SC-M27-S	08	7.5	¼	SC-M27-90	RSB12-08	CN09-08	B
	10	8.5	⅝ <sub>16</sub>	SC-M27-90	SRN07	CN07	A
	12	10	⅝ <sub>16</sub>	SC-M27-90	SRN09	CN09	A

NOTE: Order solenoid bodies, cap nuts and sealing bushes separately.

#### Solenoid connector interfaces

Elbow fitting Part No.	Thread	Nominal dimensions (mm)				Nut colour
		A	B	C	D	
SC-M24-90	M24 x 1.0mm	31.3	8.5	40.5	Black	
SC-M27-90	M27 x 1.0mm	34.0	40.4	0.5	Grey	

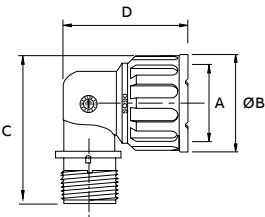

Straight fitting Part No.	Thread	Nominal dimensions (mm)				Nut colour
		A	B	C	D	
SC-M24-S	M24 x 1.0mm	31.0	53.0	-	Black	
SC-M27-S	M27 x 1.0mm	34.0	54.0	-	Grey	

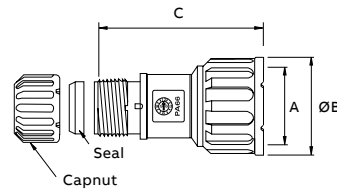

NOTE: Dimensions refer to overall assembly.

#### RSG Housing - Sealed fittings

Part No.	Suitable for connector type	Number of pins	Nominal dimensions (mm)			
			A	B	C	D
RSG02	M27	2	25.0	3.5	18.7	23
RSG03	M27	3	25.3	3.5	18.0	21
RSG04	M27	4	25.3	3.5	18.7	23
RSG05	M24	2	22.5	3.5	18.0	23
RSG06	M24	3	22.3	3.5	18.0	21

